

INTÉGRUS ARCHITECTURE

10 SOUTH CEDAR STREET
SPOKANE, WASHINGTON 99204
509.838.8881 FAX 838.2194
LMNARCHITECTS

801 SECOND AVENUE, SUITE 501
SEATTLE, WASHINGTON 98104
206.882.3460 FAX 343.9388

CONSTRUCTION SET

(REVISED—BID PACKAGE 6)

SPOKANE
CONVENTION CENTER
EXPANSION

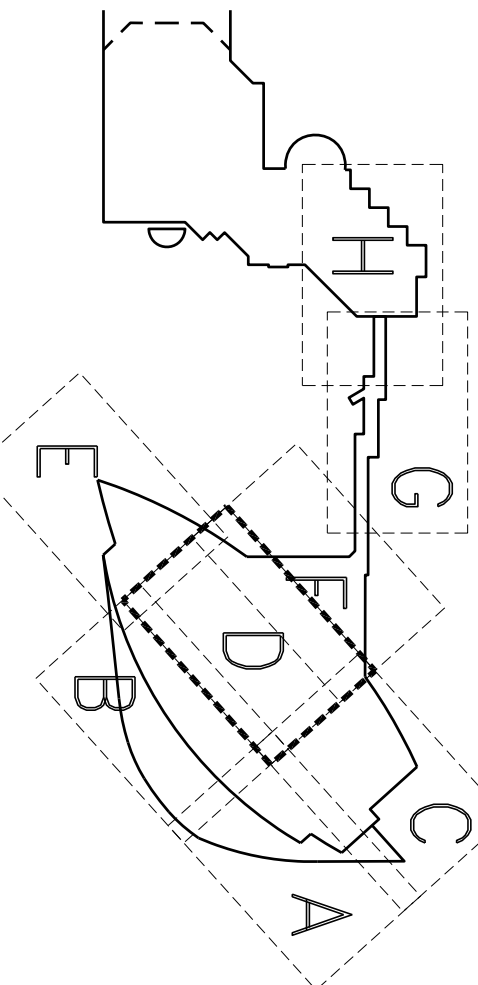

REVISIONS		
NO.	DATE	DESCRIPTION
1	10-20-04	BR-1 ADDENDUM #1
2	10-28-04	BR-1 ADDENDUM #2
3	11-04-04	BR-1 ADDENDUM #3
4	01-21-05	BR-1 CLARIFICATION DWG
5	3-07-05	BR-2
6	4-15-05	CD 025

DESIGNED	
DRAWN	T.A./H
CHECKED	J.D.C.
DATE	4-15-05
GRID FILE	
GRID FILE	150a_-01D.dwg
JOB NUMBER	
JOB NUMBER	20150.000

TITLE
PARKING LEVEL 01
FOUNDATION
SECTOR D

S1.1D

